

气体放电管

Gas discharge tube

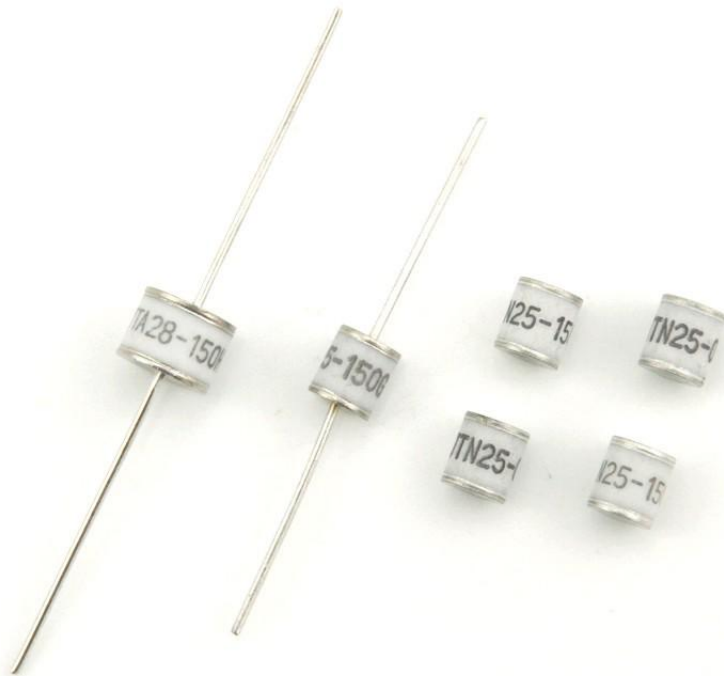

优良品质 · 诚信经营

一起携手 · 共创辉煌

VDKA28H/VDKN28H

产品简介

DESCRIPTION

Gas discharge tubes (GDT) use noble gasses enclosed in ceramic tubes to provide an alternate circuit path for voltage spikes. The ceramic envelope and with nickel connectors allow for high loads and Ruilon offers products that function at 20KA, 40KA, 50KA, 60KA, 100KA & 150KA. The breakdown voltages of the devices have a wide range (up to 20% tolerance). Major applications are high frequency telecommunication lines, stations, security systems, HID and high quality Surge Protection Devices (SPD).

产品特征

FEATURES

- RoHS & HF compliant
- Size: 8.0mm*6.0mm
- DC Spark-over voltage: 75~800V
- Stable breakdown voltage.
- High insulation resistance.
- High holdover voltage.
- Large absorbing transient current capability.
- Low Capacitance
- Micro-Gap Design

产品应用

APPLICATIONS

- Cable Modem
- xDSL
- Set-Top Box
- Satellite and CATV equipment
- Power supplier
- Consumer electronics
- General telecom equipment

产品型号

Product Identification

VDK A 2 8-075 H

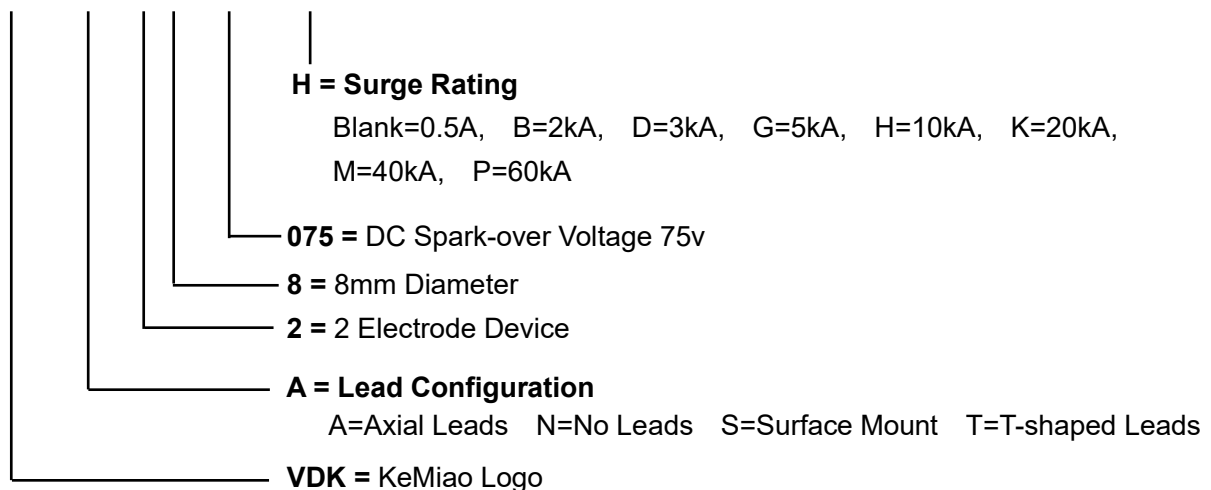

性能规范
Performance Specification

Part Number	DC Spark-over Voltage	Maximum Impulse Breakdown Voltage		Max. Impulse Discharge Current (8/20 μ s)		Impulse Life (10/1000 μ s)	Normal Alternating Discharge Current		DC Holdover Voltage	Minimum Insulation Resistance	Maximum Capacitance (1MHz)
	100V/S	kV/ μ S	kV/ μ S	1 times	10 times	100A	50Hz 1Sec	Single 9 Cycles			
	(V)	(V)	(V)	(KA)		Times	(A)				
VDKA28-070H	70 \pm 20%	500	600	15	10	300	10	65	52	1	1.5
VDKA28-075H	75 \pm 20%	500	600	15	10	300	10	65	52	1	1.5
VDKA28-090H	90 \pm 20%	500	600	15	10	300	10	65	52	1	1.5
VDKA28-120H	120 \pm 20%	500	700	15	10	300	10	65	52	1	1.5
VDKA28-130H	130 \pm 20%	500	700	15	10	300	10	65	52	1	1.5
VDKA28-150H	150 \pm 20%	500	700	15	10	300	10	65	52	1	1.5
VDKA28-230H	230 \pm 20%	500	700	15	10	300	10	65	80	1	1.5
VDKA28-250H	250 \pm 20%	500	700	15	10	300	10	65	135	1	1.5
VDKA28-300H	300 \pm 20%	700	900	15	10	300	10	65	150	1	1.5
VDKA28-350H	350 \pm 20%	700	900	15	10	300	10	65	150	1	1.5
VDKA28-400H	400 \pm 20%	800	1000	15	10	300	10	65	150	1	1.5
VDKA28-470H	470 \pm 20%	900	1100	15	10	300	10	65	150	1	1.5
VDKA28-600H	600 \pm 20%	1100	1300	15	10	300	10	65	150	1	1.5
VDKA28-800H	800 \pm 20%	1300	1500	15	10	300	10	65	150	1	1.5
VDKN28-070H	70 \pm 20%	500	600	15	10	300	10	65	52	1	1.5
VDKN28-075H	75 \pm 20%	500	600	15	10	300	10	65	52	1	1.5
VDKN28-090H	90 \pm 20%	500	600	15	10	300	10	65	52	1	1.5
VDKN28-120H	120 \pm 20%	500	700	15	10	300	10	65	52	1	1.5
VDKN28-130H	130 \pm 20%	500	700	15	10	300	10	65	52	1	1.5
VDKN28-150H	150 \pm 20%	500	700	15	10	300	10	65	52	1	1.5
VDKN28-230H	230 \pm 20%	500	700	15	10	300	10	65	80	1	1.5
VDKN28-250H	250 \pm 20%	500	700	15	10	300	10	65	135	1	1.5
VDKN28-300H	300 \pm 20%	700	900	15	10	300	10	65	150	1	1.5
VDKN28-350H	350 \pm 20%	700	900	15	10	300	10	65	150	1	1.5
VDKN28-400H	400 \pm 20%	800	1000	15	10	300	10	65	150	1	1.5
VDKN28-470H	470 \pm 20%	900	1100	15	10	300	10	65	150	1	1.5
VDKN28-600H	600 \pm 20%	1100	1300	15	10	300	10	65	150	1	1.5
VDKN28-800H	800 \pm 20%	1300	1500	15	10	300	10	65	150	1	1.5

DC Spark-over Voltage	DC Measuring Voltage
70-90V	50V
120-400V	100V
470-800V	250V

焊接参数
SOLDERING PARAMETERS

Reflow Condition		Pb-Free Assembly
Pre Heat	-Temperature Min ($T_{s(min)}$)	150°C
	-Temperature Max($T_{s(max)}$)	200°C
	-Time (T_{smin} to T_{smax})	60~180 seconds
Average Ramp-up Rate (Liquidus Temp (T_L) to peak)		3°C/second Max
$T_{s(max)}$ to T_L - Ramp-up Rate		5°C/second Max
Reflow	-Temperature (T_L) (Liquidus)	217°C
	-Time (min to max) (t_s)	60~150 seconds
Peak Temperature (T_p)		260 ^(+0/-5) °C
Time within 5°C of actual Peak Temperature (t_p)		10~30 seconds
Ramp-down Rate		6°C/second Max
Time 25°C to Peak Temperature		8 minutes Max
Do not exceed		260°C

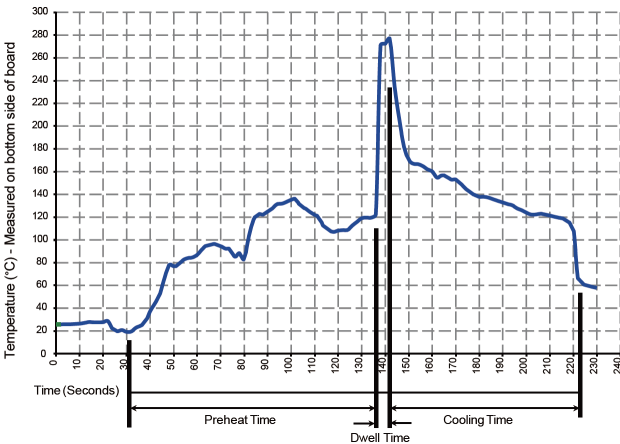
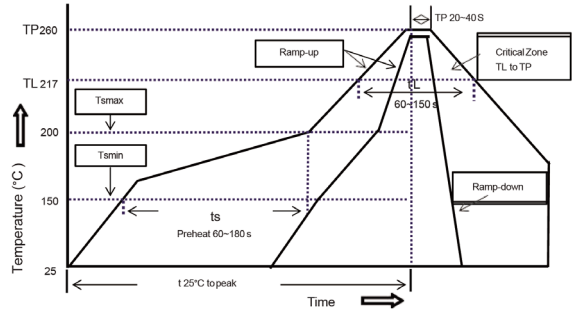
Recommended Process Parameters:

Wave Parameter	Lead-Free Recommendation
Preheat: (Depends on Flux Activation Temperature)	(Typical Industry Recommendation)
Temperature Minimum:	100°C
Temperature Maximum:	150°C
Preheat Time:	60-180 seconds
Solder Pot Temperature:	260°C Maximum
Solder Dwell Time:	2-5 seconds

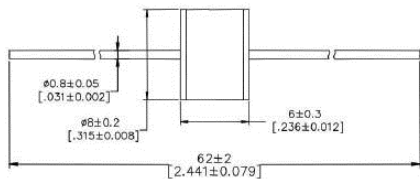
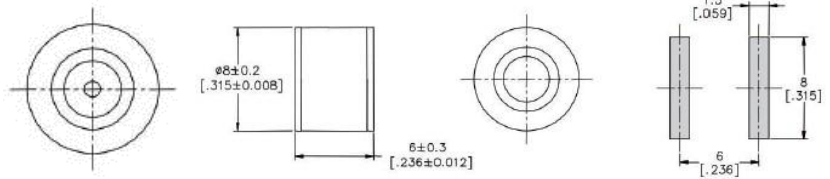
尺寸单位
Dimension unit:(mm)
DIP Series (2RxxxxT-8)

SMB Series (2RxxxxS-8)

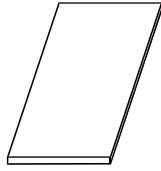
Recommended Soldering Pad Layout

包装规格 Packaging Taping
For " T " Type Axial Lead Items

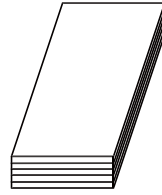
 Plastic Tray
 (252x135x10mm)

100 PCS/ Plastic Tray

 Inner Box
 (270x145x50mm)

500 PCS/ Box

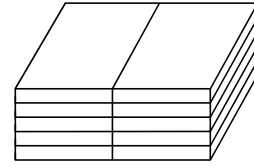
 Outside Box
 (310x280x275mm)

5,000 PCS/ Carton

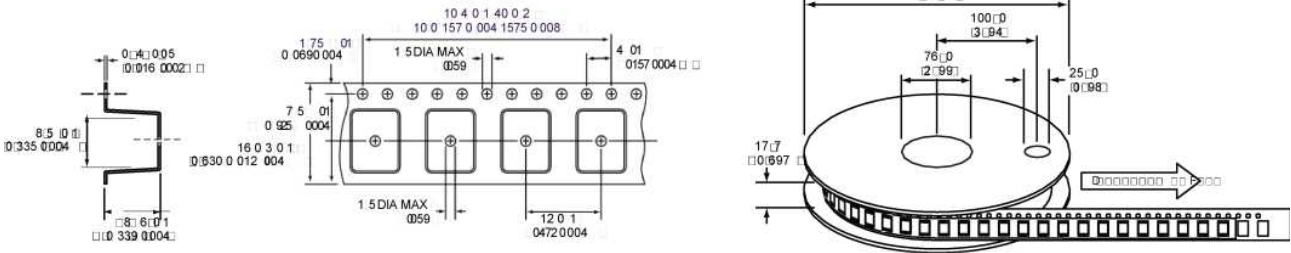
Core and ' S ' Type Items

储存要求 Warehouse Storage Conditions of Products

Storage Conditions:

1. Storage Temperature: -10°C~+40°C
2. Relative Humidity:<75%RH
3. Keep away from corrosive atmosphere and sunlight.

Period of Storage: 1 year